

Class Brownsons Land

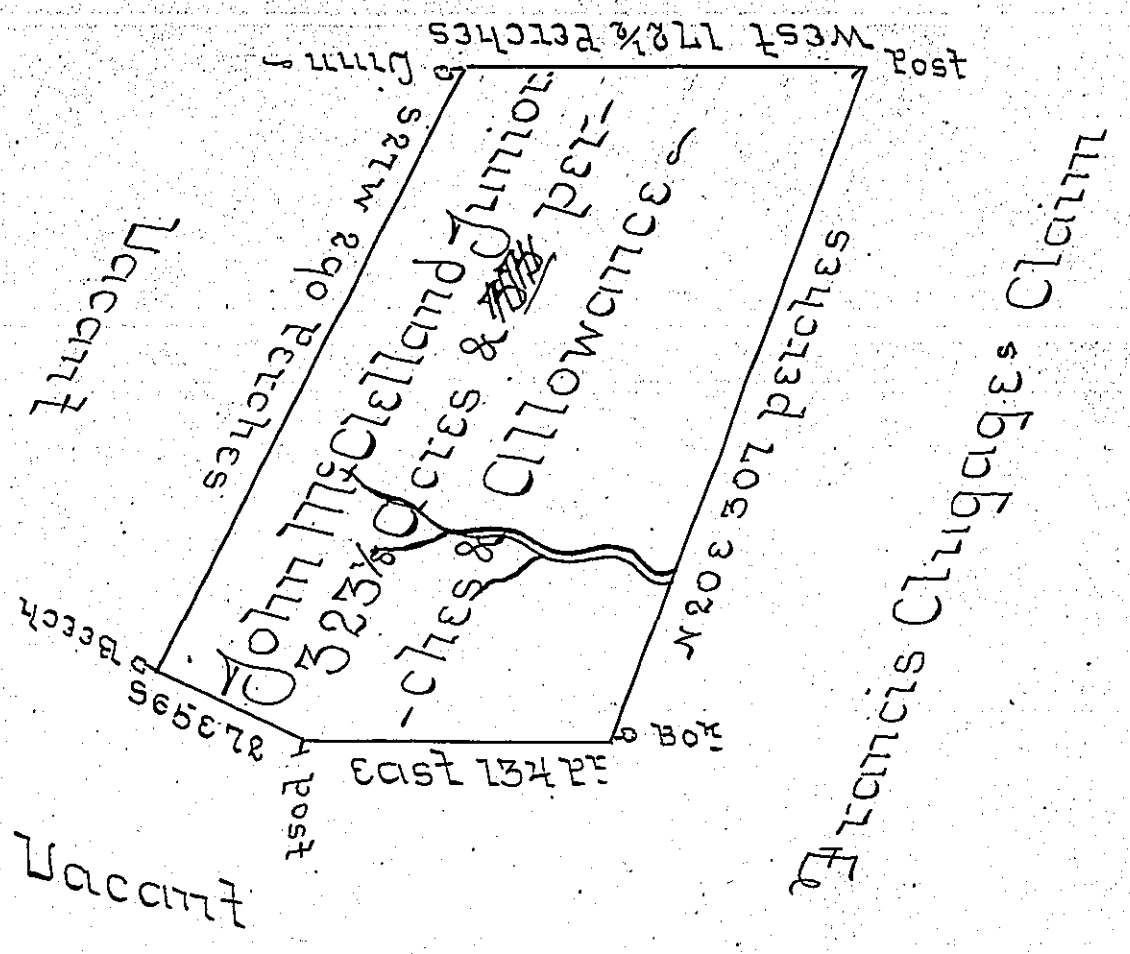

A Draught of a Tract of Land Situate in Bedford County on the Waters of Conemaugh and Clearfield Creek adjoining Land of Alsa Brownson & Francis Clugage Containing 323 Acs & 33 Perches & the Usual Allowance of Six Per Cent for Roads Surveyed the 27th Day of June 1765 in Pursuance of a Warrant Granted to John McClelland Junior Dated Febr. 23^d 1765

George Woods US

To John Suters Esq^r Secy

IN TESTIMONY that the above is a copy of the original remaining on file in the Department of Internal Affairs of Pennsylvania, made conformably to an Act of Assembly approved the 16th day of February, 1833, I have hereunto set my Hand and caused the Seal of said Department to be affixed at Harrisburg, this twenty fourth day of November 1905.

Francis B. Brown
Secretary of Internal Affairs.